

estate agents **auctioneers**

**hollis  
morgan**



GF, 68 Hampton Park, Redland, Bristol, BS6 6LJ

£270,000

Hollis Morgan - A charming raised garden apartment complete with allocated parking and communal gardens, positioned in a handsome period building. Cosmetic updating required.

- Raised Garden Apartment
- Period Conversion
- Two Bedrooms
- Scope for Improvement
- Communal Gardens
- No Onward Chain
- Allocated Parking Space

**Description**

This period apartment occupies the lower level of an attractive period building located on the ever popular "Hampton Park" internally the property offers spacious accommodation comprising entrance hall, open plan living area with bay window and fully fitted kitchen, two double bedrooms and bathroom suite with separate W.C. Whilst the property has been well maintained over the years it now requires some basic cosmetic updating throughout. Further benefits include use of communal gardens and allocated parking.

**Living room**

14'7" x 13'9" (4.45 x 4.20)

Double glazed sash bay to front, electric heater.

**Kitchen Area**

6'5" x 11'4" (1.97 x 3.47)

Range of matching wall and base units, laminated worktops, stainless steel sink with mixer tap, tiled surrounds and splash backs, plumbing for washing machine and extractor fan.

Additional storage/pantry.

**Bedroom 1**

13'8" x 12'0" (4.19 x 3.68)

Double bedroom with double glazed window to rear, electric heater. Ample storage space.

**Bedroom 2**

7'3" x 8'3" (2.22 x 2.53)

Double glazed window to rear, electric heater

**Bathroom**

Electric shower over bath, basin, extractor fan and cupboard housing hot water heater/tank.

**Garden**

Large communal garden to rear mainly laid to lawn.

**Location**

Hampton Park is located in the ever desirable Redland, Local amenities and services are all within close proximity including the popular Chandos Road which offers an array of affluent bars, cafes and restaurants. The ever popular Whiteladies Road is also within walking distance whilst Bristol City Centre is approximately two miles away. Bristol University and the Bristol Royal Infirmary are within half a mile.

**Parking**

Allocated parking for one vehicle. Residents parking also available.

**Tenure/Management Information**

Residue of 999 years.

Management Fee: £150pcm



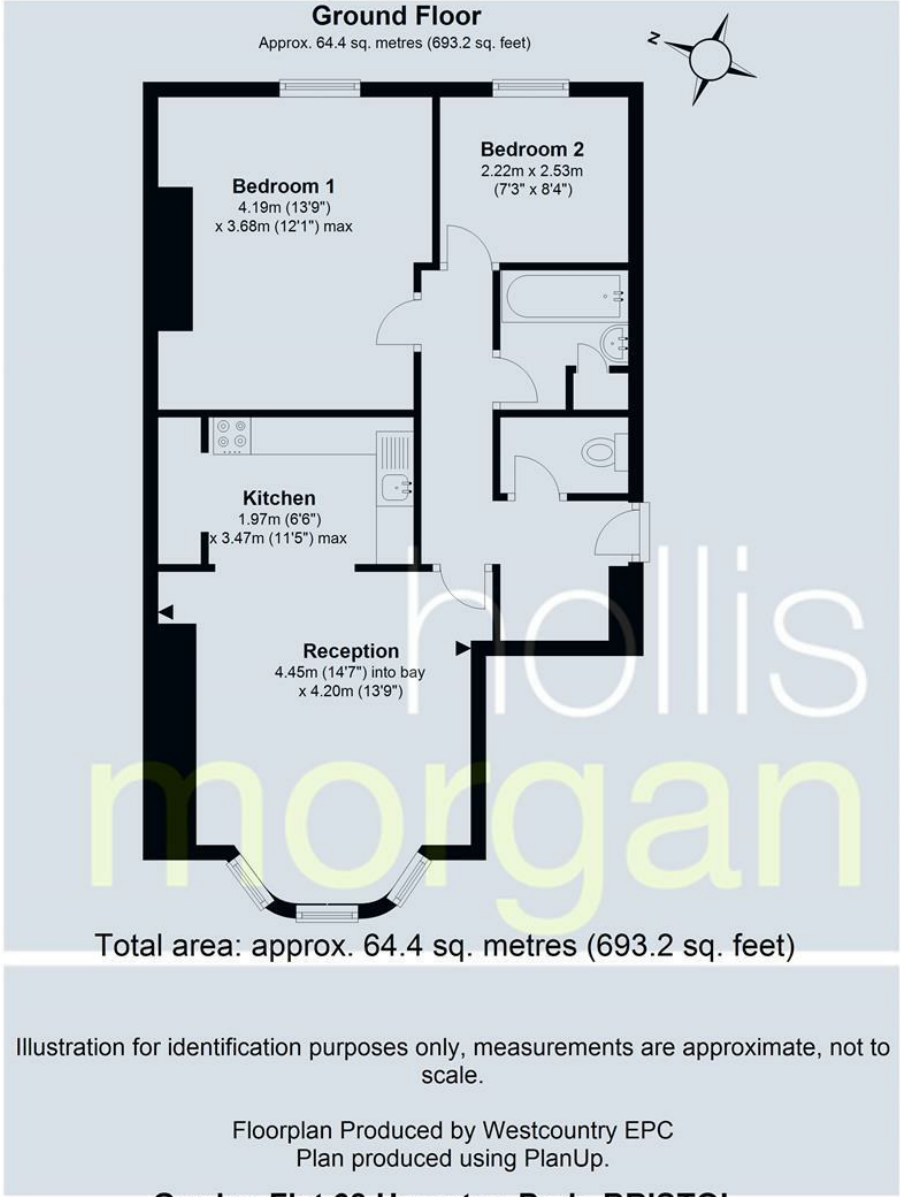

TEL | **0117 933 9522** | 9 Waterloo Street, Clifton, Bristol BS8 4BT

[www.hollismorgan.co.uk](http://www.hollismorgan.co.uk) | [post@hollismorgan.co.uk](mailto:post@hollismorgan.co.uk)  
Hollis Morgan Property Limited, registered in England, registered no 7275716  
Registered address, 5 Upper Belgrave Road, Clifton, Bristol BS8 2XQ

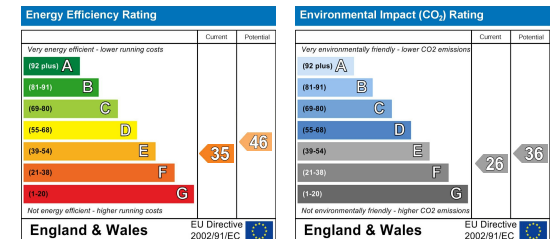

hollis  
morgan

---